

# Investing in the Roads to Possibility

The Town of Milton is investing in community infrastructure to make your travel safe and accessible. We thank you for your patience. During construction, the public is encouraged to plan travel in advance, consider alternate routes, follow signage and be patient while traveling in and around construction areas.

## Appleby Line Reconstruction

### Location

Appleby Line from 80 m north of entrance to 7145 Appleby Line to 160 m south of entrance to 7145 Appleby Line

### Project Description

This project involves widening and reconstruction of the hairpin curve to permit improved traffic operations through the curve.

#### Enhancements include:

- For 2024, final paving and miscellaneous work will be completed

### Road Closures

Appleby Line will be closed to through traffic June-July 2024. Local access will be maintained.

All road closures can be found using our interactive road closure map at [milton.ca/RoadClosures](https://milton.ca/RoadClosures).

Detour route traffic will be detoured via Derry Road, Bell School Line and 14 Side Road.

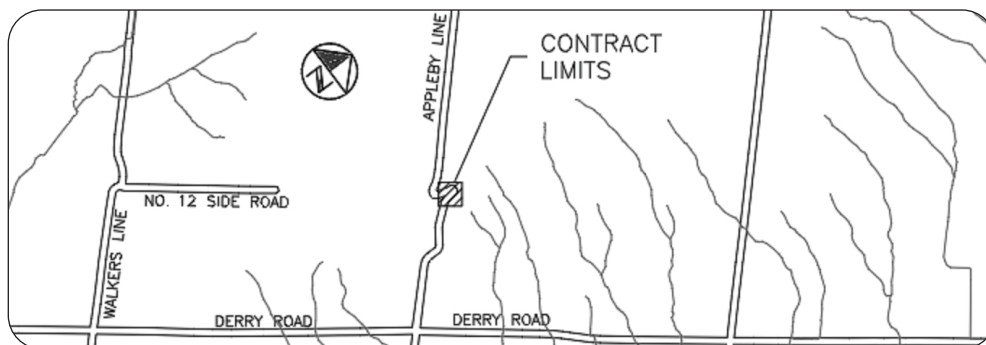

### Schedule

**Start Date:** June 2024

**Completion:** July 2024

### Project Team

WSP will be providing construction inspection and contract administration services on behalf of the Town of Milton.

For more information please contact:

#### David Sinke

Consultant Project Manager  
WSP Canada Inc.  
Burlington ON L7N 3W5  
(905) 630-5842  
[david.sinke@wsp.com](mailto:david.sinke@wsp.com)

Construction timelines are dependent on many factors, including weather. Follow [@TownofMiltonON](https://www.facebook.com/TownofMiltonON) on Facebook and Twitter for any schedule changes.

Town-led construction is essential municipal work to ensure Milton's infrastructure remains safe, in state of good repair and able to meet the community's needs now and in the future.

For more information about the project and road closures throughout the Town, visit [milton.ca/Roads](https://milton.ca/Roads).